

**Davies Remanufactured**  
**KNOLL MORRISON**



**DISASSEMBLY INSTRUCTIONS**



# Davies Remanufactured Knoll Morrison

## **DISASSEMBLY INSTRUCTIONS**

### STANDARD TOOLS REQUIRED

---



Hex Key or Allen Wrench:

5/16th Wrench

7/32th Wrench



Standard Flat-Head Screwdriver  
(optional)



Needle Nose Pliers (optional)

**DAVIES**   
office refurbishing, inc.

**WHAT LEGENDS ARE RE-MADE OF**

# Davies Remanufactured Knoll Morrison

## DISASSEMBLY INSTRUCTIONS

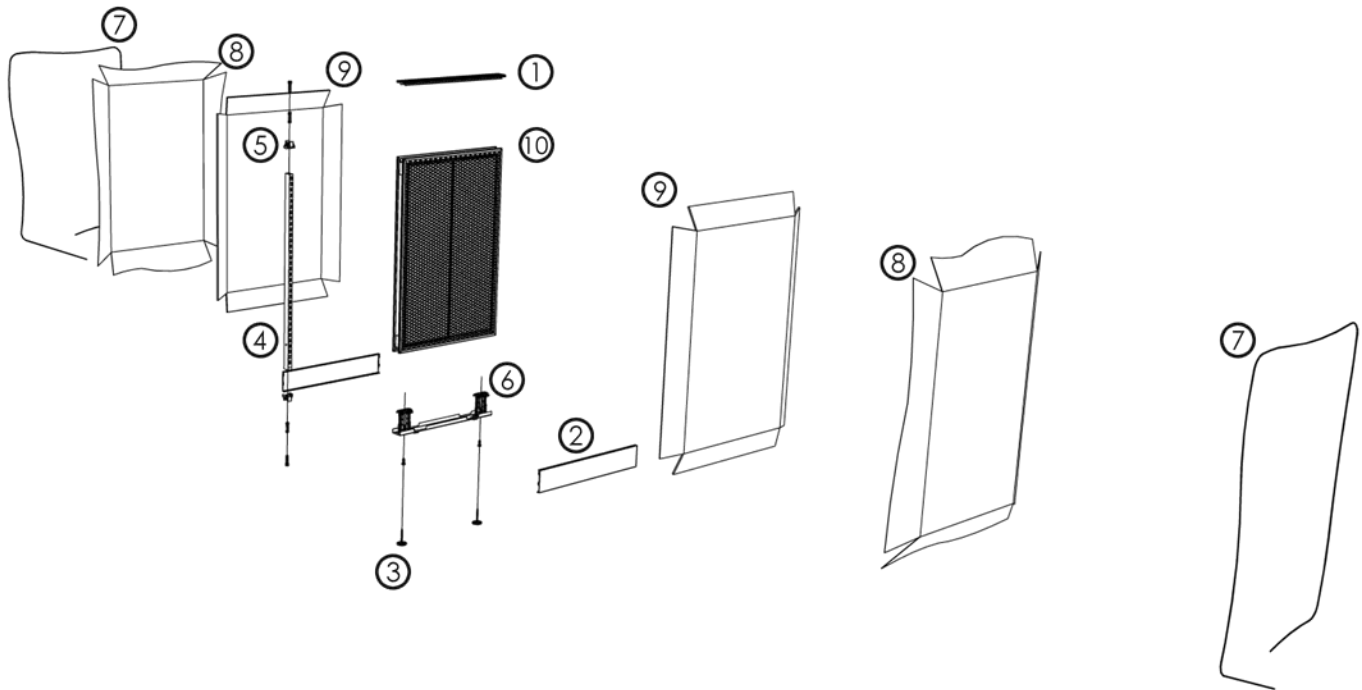

- |  |   |
|--|---|
| ① (1) Top-Cap (vinyl)                              | ⑥ (1) Base Raceway Posts/Base (steel) ♻️  |
| ② (2) Kick Plate (steel) ♻️                        | ⑦ (2) Paper Retention Cord (paper)        |
| ③ (2) Height Adjustment Glides (steel / plastic)   | ⑧ Panel Fabric (polyester/wool)           |
| ④ (1) Panel - To - Panel Connector Rail (steel) ♻️ | ⑨ Insulation Batting (cotton)             |
| ⑤ (2) Rail-To-Panel Attachment Brackets (steel) ♻️ | ⑩ Panel Core (steel/fiberglass/cardboard) |

Misc. Hardware (steel) ♻️



♻️ Items that should be recycled if they cannot be re-used or remanufactured. For more information on where to recycle materials or other recovery options, please review the Davies End of Life Recycling infrastructure Matrix and Davies End of Life Recovery Options Matrix.

Available online at: <http://daviesoffice.com/environment/>



**WHAT LEGENDS ARE RE-MADE OF**

# Davies Remanufactured Knoll Morrison

## **DISASSEMBLY INSTRUCTIONS**



### STEP 1

Remove top cap by pulling top cap straight up with both hands.

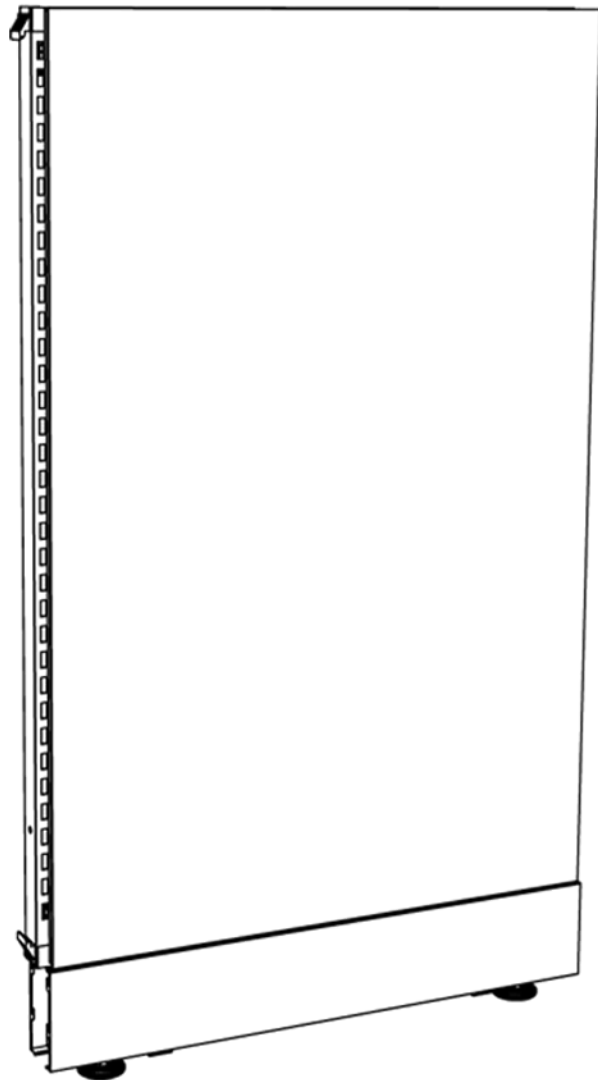

# Davies Remanufactured Knoll Morrison

## DISASSEMBLY INSTRUCTIONS

### STEP 2

Using your fingertips, pull the base of the kick-plate to you, until it is free of the bottom clips.

Once the bottom of the kick-plate is free you can lift the kick-plate off of it's hinge brackets.

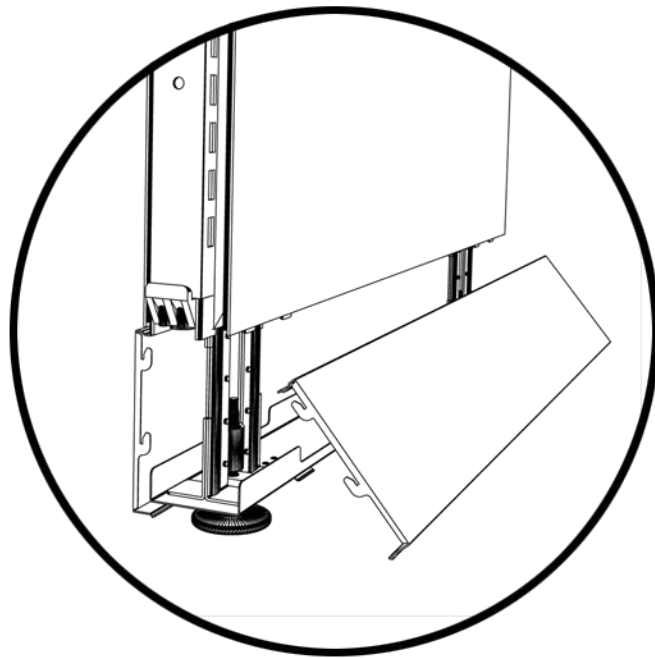
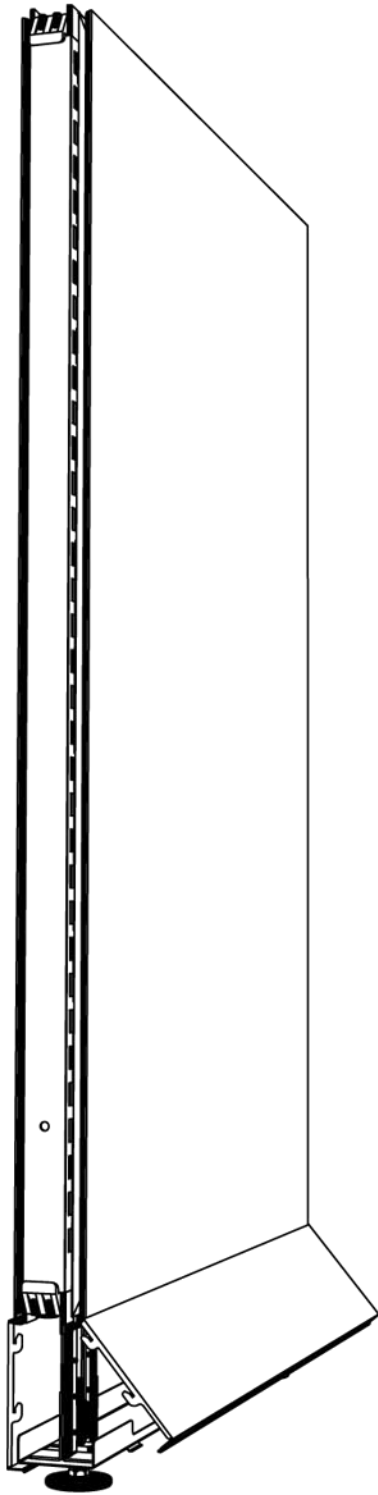

**DAVIES**  
office refurbishing, inc. 

**WHAT LEGENDS ARE RE-MADE OF**

# Davies Remanufactured Knoll Morrison

## DISASSEMBLY INSTRUCTIONS

### STEP 3

Repeat STEP 2 for the other side of the panel.

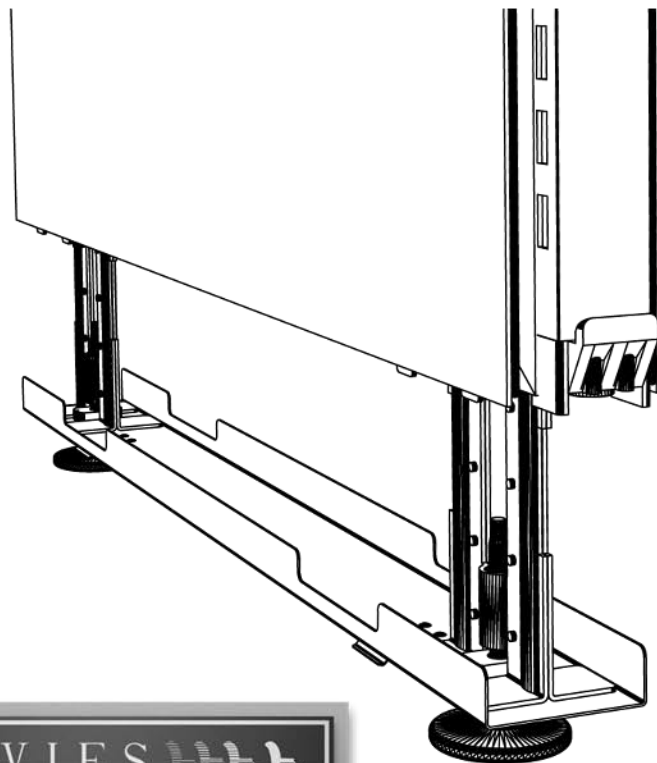
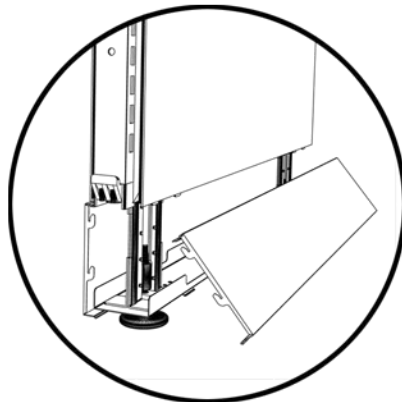
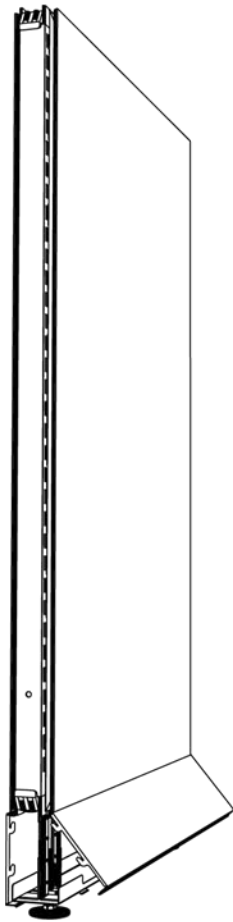

**DAVIES**  
office refurbishing, inc.



**WHAT LEGENDS ARE RE-MADE OF**

# Davies Remanufactured Knoll Morrison

## DISASSEMBLY INSTRUCTIONS

### STEP 4

Using a 5/16th Allen wrench, loosen and remove the bolts on the top and bottom of the Panel-To-Panel connector rail.

Once the bolts have been removed, the springs and brackets can be taken off of the top and bottom of the rail.

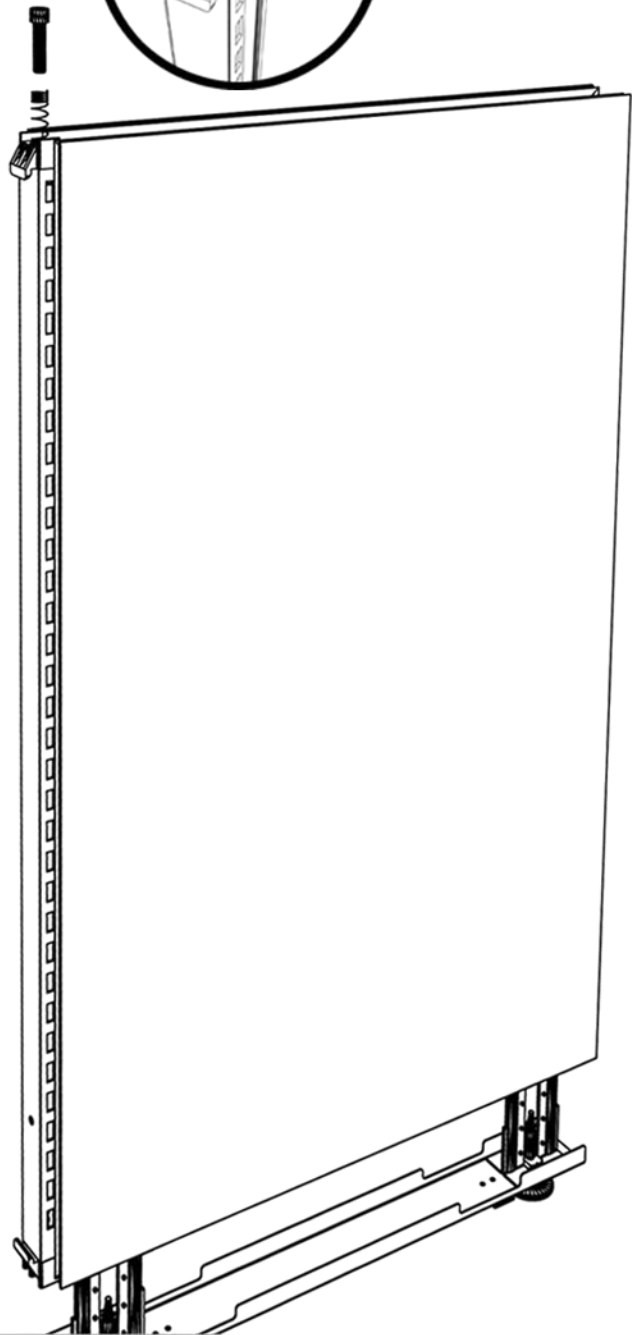
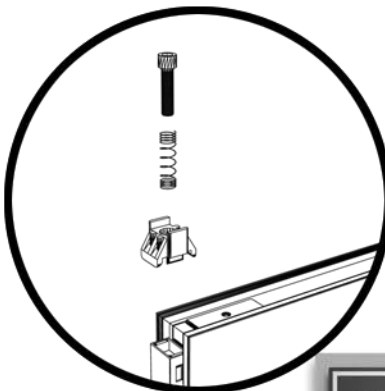
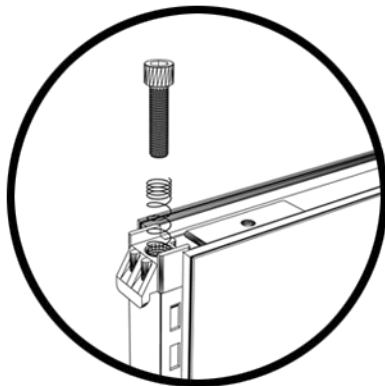
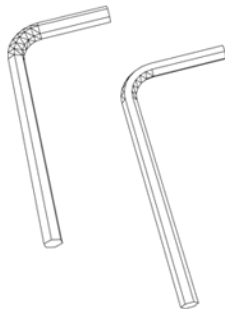

**DAVIES**  
office refurbishing, inc.



**WHAT LEGENDS ARE RE-MADE OF**

Davies Remanufactured Knoll Morrison  
**DISASSEMBLY INSTRUCTIONS**

# STEP 4 (cont)

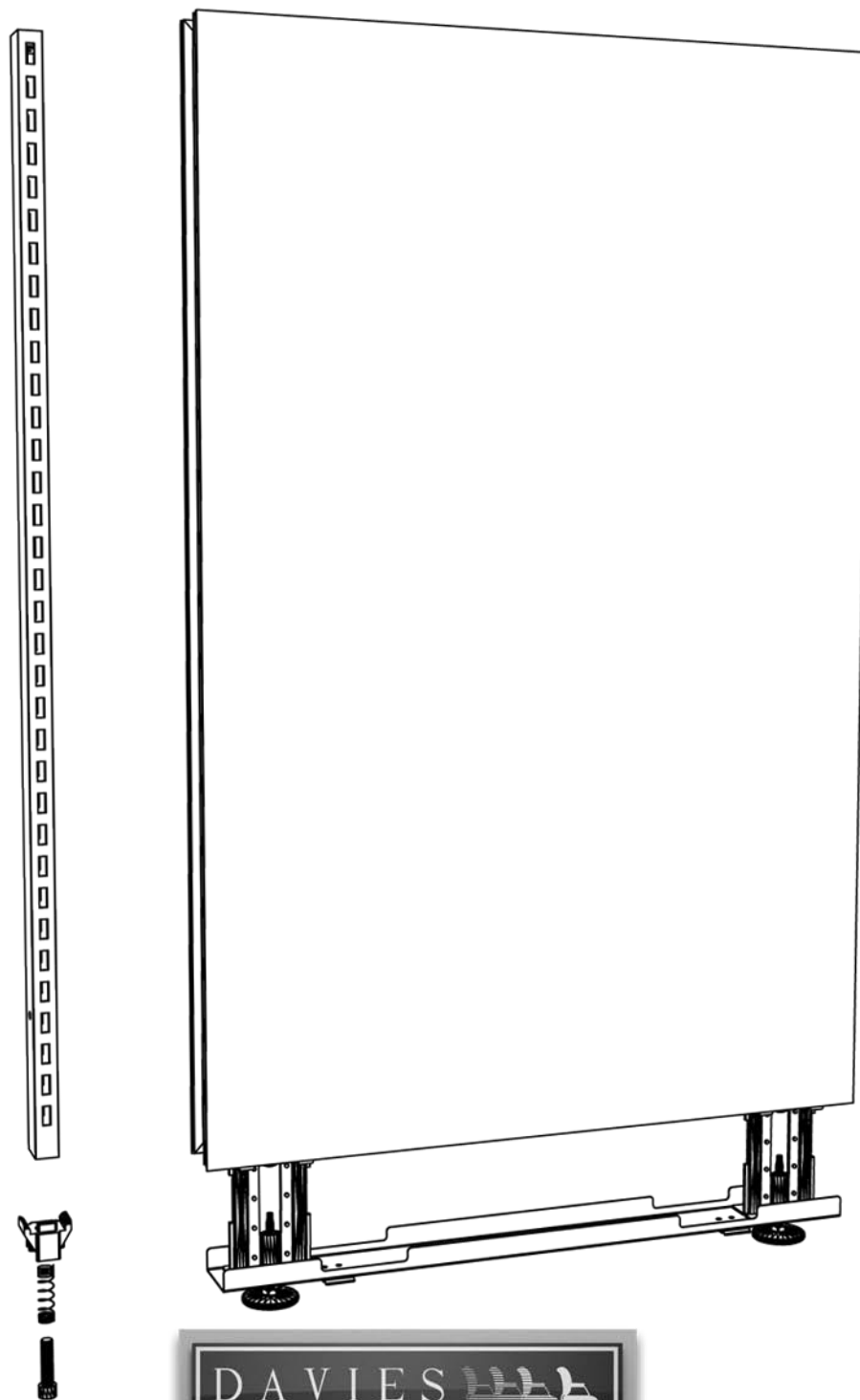

**WHAT LEGENDS ARE RE-MADE OF**



# Davies Remanufactured Knoll Morrison

## DISASSEMBLY INSTRUCTIONS

### STEP 5

Glides can, almost always, be removed by unscrewing them by hand.

If you find that a glide is too difficult to remove by hand, use a pair of pliers or a wrench to remove them.

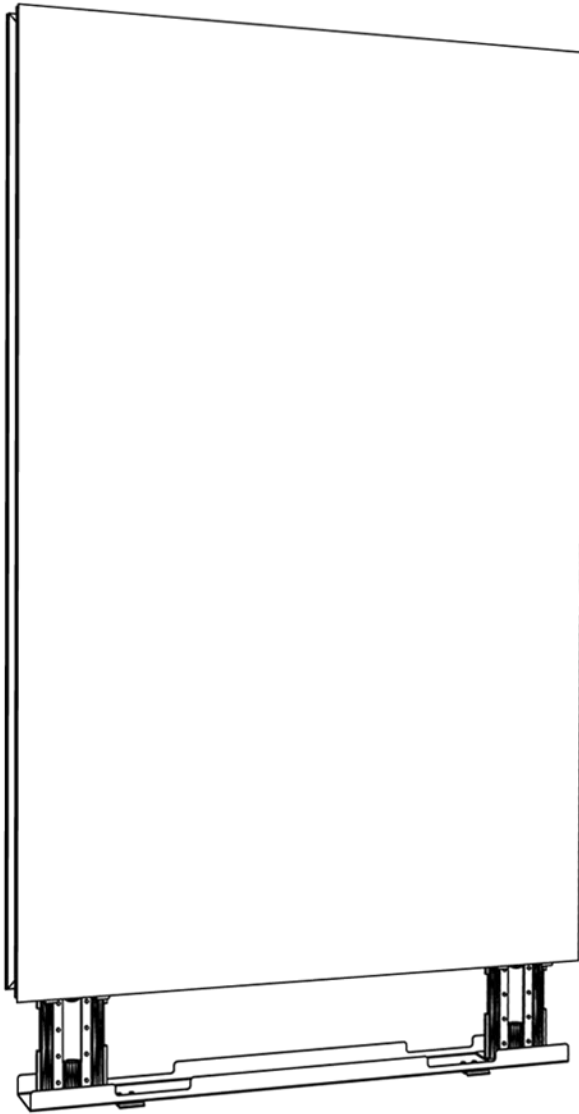

**DAVIES**   
office refurbishing, inc.

**WHAT LEGENDS ARE RE-MADE OF**

# Davies Remanufactured Knoll Morrison

## DISASSEMBLY INSTRUCTIONS

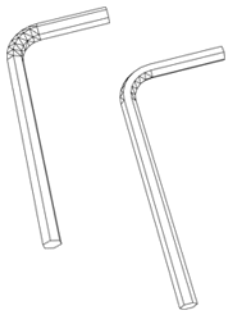

### STEP 6

Use a 7/32th allen wrench to remove the (2) bolts that hold the base to the panel frame.

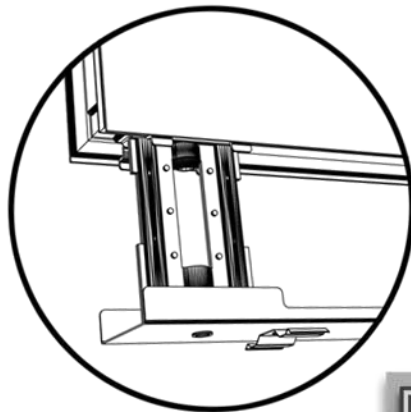
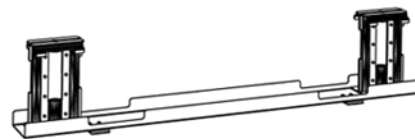
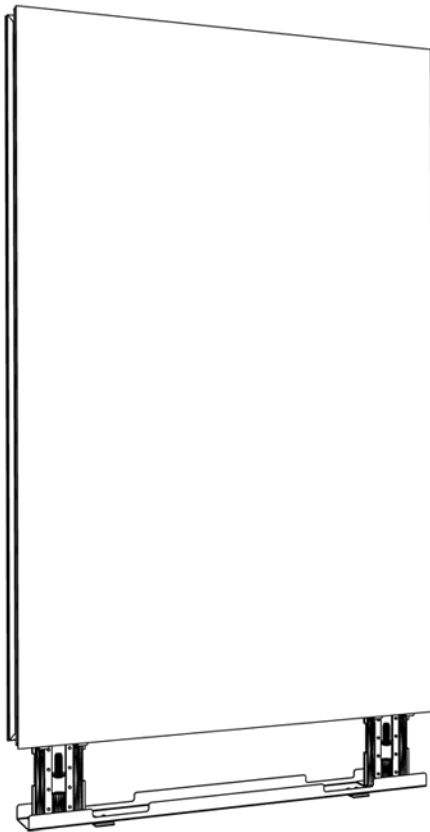

**DAVIES**   
office refurbishing, inc.

**WHAT LEGENDS ARE RE-MADE OF**

# Davies Remanufactured Knoll Morrison

## DISASSEMBLY INSTRUCTIONS

### STEP 7

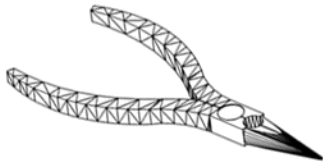

The fabric panel skins are applied to the panel frame with a paper cord that is wrapped around a channel, that runs around the outside of the panel frame.



Lay the panel down and pull out the paper retention cord.

It may be helpful to use a flat-head screwdriver or needle nose pliers to grasp the end of the cord.

Once the cord has been removed you'll be able to take the fabric and acoustical batting off of the panel.

NOTE: REPEAT FOR BOTH SIDES OF THE PANEL.

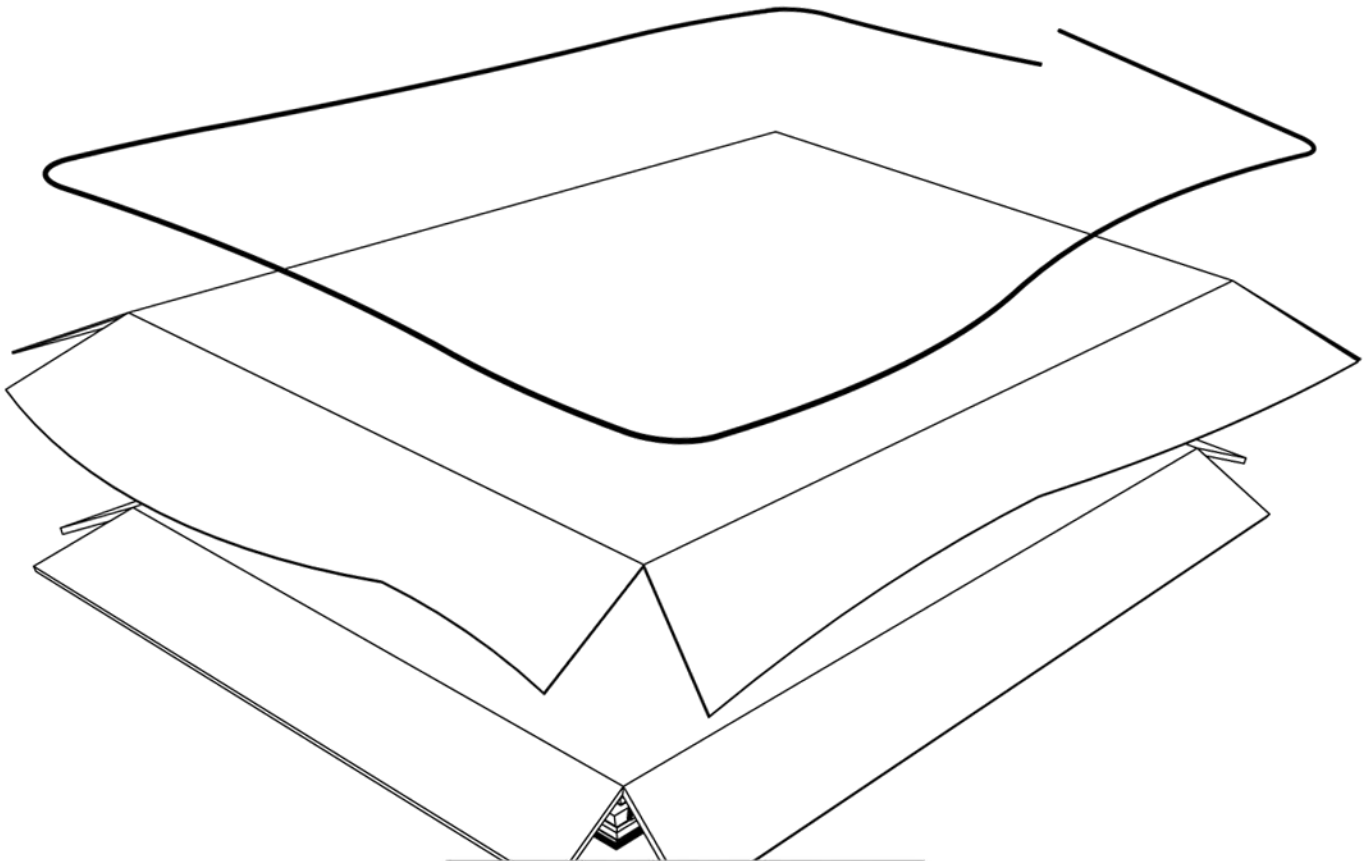

**DAVIES**  
office refurbishing, inc. 

**WHAT LEGENDS ARE RE-MADE OF**

# Davies Remanufactured Knoll Morrison

## DISASSEMBLY INSTRUCTIONS

# COMPLETE

What's left is the Knoll Morrison panel core. This is as far as you can disassemble the Morrison panel using standard hand tools.

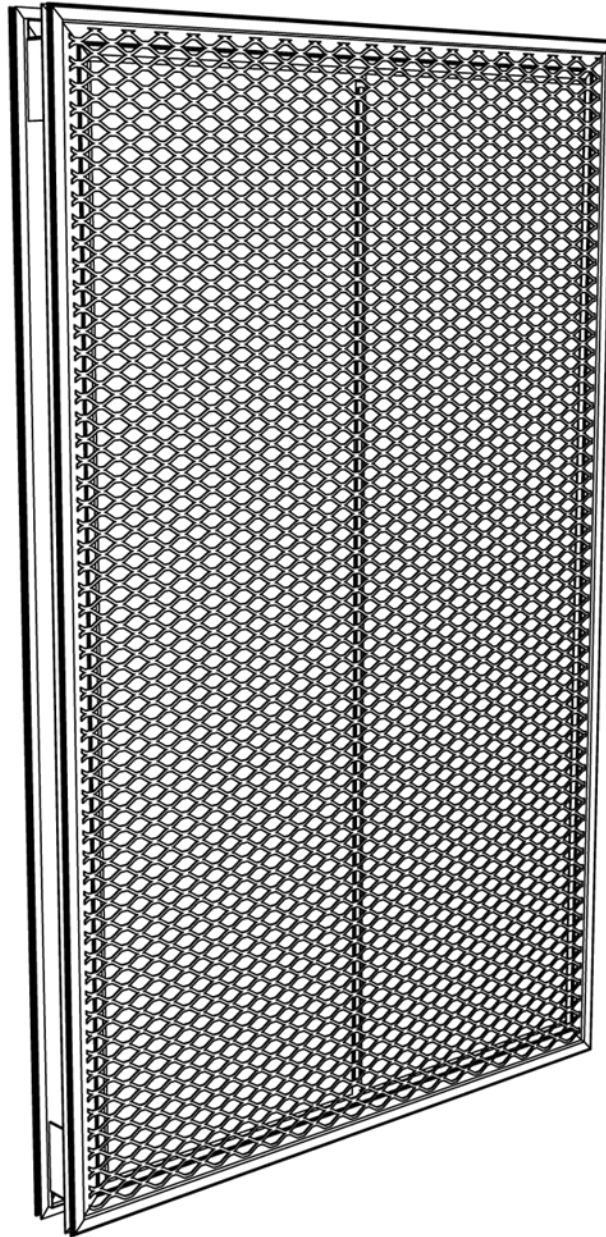

**WHAT LEGENDS ARE RE-MADE OF**